

# STREAMLINE WORKFLOWS WITH AUTOMATION AND SECURED CLOUD CONNECTIVITY

Canon's high performing imageRUNNER ADVANCE DX 6980i is an A3 multifunction device that improves business efficiency by delivering fast, high quality black and white prints suited to fast paced office environments.

Canon imageRUNNER ADVANCE DX  
6980i

Mono Multifunction Device ●○



## PRODUCTIVITY

**Save time and resources with increased workflow productivity**

- A3 mid-to-high-volume mono device with a printing speed up to 80ppm.
- Intuitive, user-friendly interface with a large 10.1 inch WSVGA touchscreen and smartphone similarities.
- Advanced scanning technology can dramatically reduce time spent naming and saving scanned files to your cloud storage service<sup>^</sup>.
- Single-pass duplex document feeder and automatic blank page removal for streamlines digital workflows. Scan and convert documents to searchable digital files in a variety of file formats.
- Hot Folders allow users to drag and drop a file into a hot folder and automatically print with pre-defined settings such as number of copies and finishing requirements.

## COST CONTROL

**Improving operation efficiencies and better managing costs**

- Forced job hold with ability to change print settings at device enhances control over projects.
- Blank page removal eliminates paper wastage and helps with document formatting.
- Support for multiple user authentication methods and usage tracking.

## SECURITY

**Safeguard data and ensure sensitive information remains secure**

- The device boot process, firmware, and applications are verified on start up, and self repairs<sup>#</sup>.
- Drive Lock and standard SSD encryption by default, for peace of mind over stored data. Initialize All Data/Settings feature allows admins to easily remove user data at decommissioning.
- Class leading security support of TPM 2.0, TLS 1.3, HCD-PP, FIPS140-2 and SP800-193 compliant, as well as Security Information and Event Management (SIEM) support for real-time insights to potential threats.
- Industry leading malware protection utilising McAfee Embedded Control powered by Trellix, which protects against the execution of unauthorised applications and other cybersecurity threats.

## MOBILITY

**Achieve ultimate freedom and flexibility with Expanded Mobile OS Support**

- Mobile workflows are fully supported with Apple® Airprint®, Android™ Mopria™ and Canon PRINT Business app for iOS/Android. Easily allow users to connect, print, scan and capture.
- Simple and easy connectivity with multiple connection options, USB, ethernet and optional Wi-Fi, plus support for approved USB to LAN adaptors for second ethernet connection.

## SUSTAINABILITY

**Support your environmental goals with MFDs that incorporate responsible design and efficient operations**

- The DX Series makes an increased use of environmentally friendly packaging.
- Canon's fusing technologies minimises power requirements and helps achieve low energy consumption, also helps faster warm-up times.
- Canon is committed to low Typical Energy Consumption (TEC) values. The DX 6980i achieves this through features such as default 2-sided printing, blank page removal, Forced Job Hold and supports light weight GSM paper (down as low as 52 gsm) which means less pulp per page.

## INTEGRATION

**Seamlessly integrate with key line-of-business systems to fast track your digital transformation journey**

- Personalised workflows allow users to pick and choose what works best for them in terms of functionality.
- Canon's powerful Multifunctional Embedded Application Platform (MEAP), combined with a common source code for firmware, ensures that IT and office automation is smoothly aligned.
- Efficiently digitise documents with automated workflows connected to applications such as OneDrive, SharePoint, Concur, DropBox and Microsoft Teams\*.

\* Requires uniFLOW Online Print & Scan or uniFLOW Cloud Image Processing subscription.

# Boot firmware can only be repaired automatically.

# ADVANCED SCANNING

uniFLOW Online's Filing Assist<sup>^</sup> saves you time, reduces keying errors and brings consistency to your filing so you can find what you need, when you need it, anywhere you have internet access; at home, work or on the go.

Filing Assist uses pre-configured workflows that scan batches of repetitive documents including invoices, delivery notes, picking lists and orders to popular cloud services. Not only are they scanned, they are named, converted and filed – based on rules and information from the document.

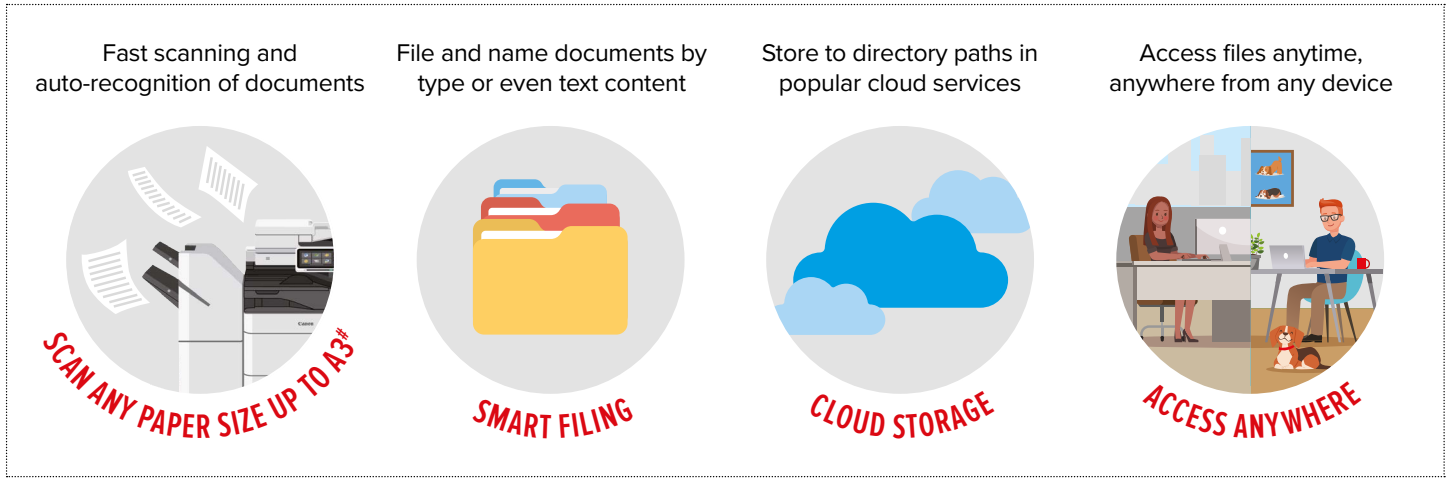

<sup>^</sup> Requires uniFLOW Online Cloud Image Processing subscription.  
<sup>#</sup> Maximum paper size depends on model of MFD.

# CONFIGURATION

This flat configuration is for illustration purposes only.  
 For a complete list of options and the exact compatibility relationships, please refer to the [online product configurator](#).

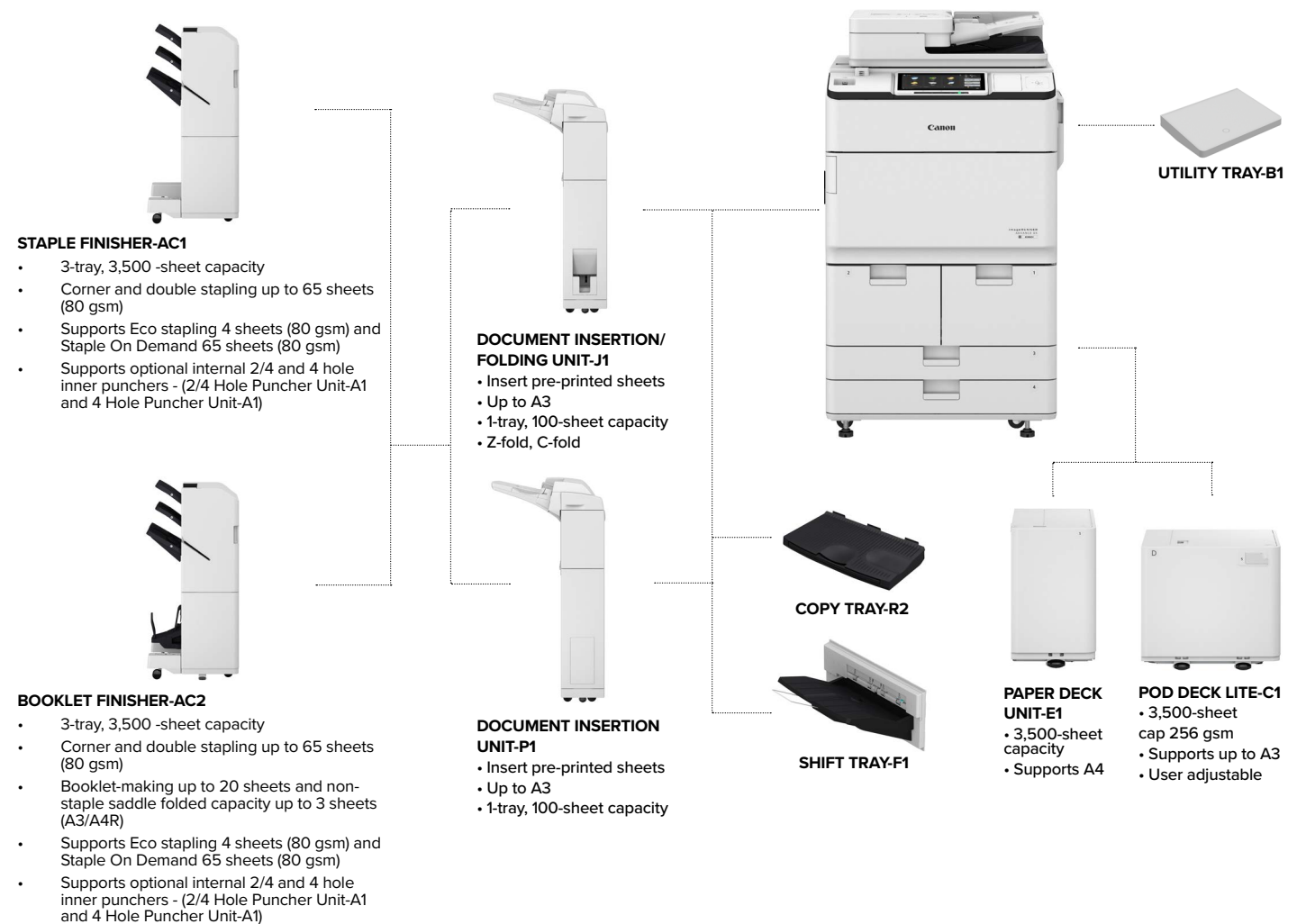

# imageRUNNER ADVANCE DX 6980i Specifications

Main Unit	
Machine Type	A3 Monochrome Laser Multifunctional
Core Function	Print, Copy, Scan, Send, Store and Optional Fax
Processor	1.8GHz Dual Core
Control Panel	10.1" TFT LCD WSVGA Colour Touch Panel
Memory	RAM 4GB
Storage	Standard: 256 GB (SSD) Optional: 1TB (SSD)
Interface Connection	Network: Standard: 1000Base-T/100Base-TX/10Base-T Optional: Wi-Fi (IEEE 802.11b/g/n) Others: Standard: USB 2.0 x 1 (Host), USB 3.0 x 1 (Host), USB 2.0 x 1 (Device) Optional: Serial Interface, Copy Control Interface
Paper Supply Capacity (A4, 80gsm)	Standard: 4,200 Sheets 100-Sheets: Multi-purpose Tray x 1 1,500-Sheets: Paper Deck x 2 550-Sheets: Paper Cassette x 2 Maximum: 7,700 sheets (with POD Deck Lite-C1 or Paper Deck Unit-E1)
Paper Output Capacity (A4, 80gsm)	Standard: 250 Sheets (with Copy Tray-R2) Maximum: 3,500 Sheets (with Staple Finisher-AC1 or Booklet Finisher-AC2)
Finishing Capabilities	Collate, Group, Offset, Staple, Saddle Stitch, Hole Punch, Eco Staple, Staple On Demand, Document Insertion, Z-fold, C-fold (Finishing capabilities vary depending on the options connected.)
Supported Media Types	Multi-purpose Tray: Thin, Plain, Recycled, Colour, Heavy, Tracing, Bond, Transparency, Label, Pre-punched, Letterhead, Tab Paper Decks (Left/Right): Thin, Plain, Recycled, Colour, Heavy, Bond, Pre-punched, Letterhead Paper Cassettes (Upper/Lower): Thin, Plain, Recycled, Colour, Heavy, Bond, Pre-punched, Letterhead, Tab* *Tab Feeding Attachment-B1 is required.
Supported Media Sizes	Multi-purpose Tray: Standard Size: A3, A4, A4R, A5 <sup>1</sup> , A5R, A6R <sup>2</sup> , B4, B5, B5R Custom Size: 100.0 x 148.0 mm to 297.0 x 487.7 mm Free Size: 100.0 x 148.0 mm to 297.0mm x 487.7mm <sup>1</sup> Supported media weights: more than 64 gsm <sup>2</sup> Supported media weights: more than 91 gsm Paper Decks (Left/Right): Standard Size: A4, B5 Paper Cassettes (Upper/Lower): Standard Size: A3, A4, A4R, A5R, B4, B5, B5R Custom Size: 139.7 x 182.0 mm to 297 x 487.7 mm
Supported Media Weights*	Multi-purpose Tray: 52 to 256 gsm Paper Decks (Left/Right): 52 to 220 gsm Paper Cassettes (Upper/Lower): 52 to 220 gsm Duplex: 52 to 220 gsm *For details of supported media, refer to the 'Available Paper' in the <a href="#">User Manual</a>
Warm-up Time	Quick Start-up Mode: 4 Seconds or less <sup>1</sup> <sup>1</sup> Time from device power-on to when the copy icon appears and is enabled to operate on the touch panel display From Sleep Mode: 30 Seconds or Less From Power On: 30 seconds or less <sup>2</sup> <sup>2</sup> Time from device power-on, until copy ready(not print reservation)
Dimensions (W x D x H)	670 x 770 x 1,185 mm
Installation Space	Depends on configuration. Please refer to the <a href="#">online product configurator</a>
Weight	Approx. 219 kg (including toner bottle)
Print Specifications	
Print Speed	Up to 80 ppm (A4), Up to 40 ppm (A3), Up to 58 ppm (A4R), Up to 35 ppm (A5R)
Print Resolution (dpi)*	1,200 x 1,200
*Laser Resolution	
Page Description Languages	Standard: UFR II, PCL6 Option: Adobe® PostScript® 3 <sup>1</sup>
Direct Print	Supported file types: PDF, EPS, TIFF/JPEG, XPS
Printing from Mobile and Cloud Applications	AirPrint®, Mopria™, Canon PRINT Business, uniFLOW Online and Universal Print. A range of software and MEAP-based solutions are available to provide printing from mobile devices or internet-connected devices and cloud-based services depending on your requirements. Please contact your sales representative for further information.
OS Standard Printing	Android™/Windows®10 <sup>1</sup> , Windows®11 <sup>1</sup> , Chrome OS™, macOS (11.2.2 or later) <sup>2</sup> , iOS (15.2 or later) <sup>2</sup> , iPadOS <sup>2</sup>  <sup>1</sup> Need to select the [Use Mopria] check box (Check the online user manual for details) <sup>2</sup> Need to select the [Use AirPrint] check box (Check the online user manual for details)
Fonts	PS Fonts: 136 Roman PCL Fonts: 93 Roman, 10 Bitmap fonts, 2 OCR fonts, Andalé Mono WT J/K/S/T <sup>1</sup> (Japanese, Korean, Simplified and Traditional Chinese), Barcode fonts <sup>2</sup> <sup>1</sup> Optional PCL International Font Set-A1 is required. <sup>2</sup> Optional Barcode Printing Kit-D1 is required.
Print Features	Secured Print, Secure Watermark, Header/Footer, Page Layout, 2-sided Printing, Mixed Paper Sizes/Orientations, Front/Back Covers, Toner Reduction, Poster Printing, Forced Hold Printing, Print Date, Scheduled Printing, Printing Using a Virtual Printer, Printing using Hot Folder
Operating System As of Feb. 2023	UFR II: Windows®10/Windows®11/Windows®Server2012/Windows®Server2012 R2 / Windows®Server2016/Windows®Server2019/Windows®Server2022, macOS®(10.13 or later) PCL: Windows®10/Windows®11/Windows®Server2012/Windows®Server2012 R2 / Windows®Server2016/Windows®Server2019/Windows®Server2022 PS: Windows®10/Windows®11/Windows®Server2012/Windows®Server2012 R2 / Windows®Server2016/Windows®Server2019/Windows®Server2022, macOS®(10.13 or later) PPD: Windows®10/Windows®11, macOS®(10.13 or later)

Copy Specifications	
Copy Speed	Up to 80 ppm (A4), Up to 40 ppm (A3), Up to 58 ppm (A4R), Up to 35 ppm (A5R)
First-Copy-Out Time (A4)	3.1 seconds (Approx.)
Copy Resolution (dpi)	600 x 600
Multiple Copies	Up to 9,999 copies
Copy Density	Automatic or Manual (9 Levels)
Magnification	Variable Zoom: 25% to 400% (1% Increments) Preset Reduction/Enlargement: 25%, 50%, 61%, 70%, 81%, 86%, 100%(1:1), 115%, 122%, 141%, 200%, 400%
Copy Features	Preset R/E Ratios by Area, 2-Sided, Density Adjustment, Original Type Selection, Interrupt Mode, Book to 2 Pages, 2-sided Original, Job Build, N on 1, Add Cover, Insert Sheets, Different Size Originals, Page Numbering, Copy Set Numbering, Sharpness, Erase Frame, Secure Watermark, Print Date, Gutter, Print & Check, Negative/Positive, Repeat Images, Merge Job Blocks, Mirror Image, Store in Mail Box, Superimpose Image, Copy ID Card, Skip Blank Pages, Free Size Original, Reserved copy, Copy Sample

Scan Specifications	
Type	Single Pass DADF-C <sup>1</sup> <sup>1</sup> Detect Feeder Multi Sheet Feed is supported.
Document Feeder	Up to 200 Sheets
Paper Capacity (80gsm)	
Acceptable Originals and Weights*	Platen: Sheet, Book, and 3-Dimensional Objects Document Feeder Media Weight: 1-sided Scanning: 38 to 220 gsm (BW, CL) 2-sided Scanning: 38 to 220 gsm (BW, CL) *An acceptable weights of A6R or smaller is 50 to 220 gsm

Supported Media Sizes	Platen Max. Scanning Size: up to 297.0 x 431.8 mm Document Feeder Media Size: A3, A4, A4R, A5, A5R, A6R, B4, B5, B5R, B6R Custom Size: 70.0 x 139.7 mm to 304.8 x 431.8 mm
Scan Speed (ppm, BW and CL; A4)	1-sided Scanning: 135/135 (300 x 300 dpi, send), 80/80 (600 x 600 dpi, copy) 2-sided Scanning: 270/270 (300 x 300 dpi, send), 160/90 (600 x 600 dpi, copy)
Scan Resolution (dpi)	Scan for Copy: 600 x 600 Scan for Send: (Push) 600 x 600 (SMB/FTP/WebDAV/IFAX), (Pull) 600 x 600 Scan for Fax: 600 x 600
Pull Scan Specifications As of Feb. 2023	Color Network ScanGear2. For both TWAIN and WIA Supported OS: Windows®10/Windows®11/Windows®Server2012/Windows®Server2012 R2 / Windows®Server2016/Windows®Server2019/Windows®Server2022
Scan Method	Push Scan, Pull Scan, Scan to Box, Scan to Advanced Box, Scan to Network, Scan to USB Memory Key, Scan to Mobile Devices, Scan to Cloud(requires uniFLOW Online)

Send Specifications	
Destination	Standard: E-mail/Internet FAX (SMTP), SMB, FTP, WebDAV, Mail Box Optional: Super G3 FAX, IP Fax
Address Book	LDAP (2,000)/Local (1,600)/Speed Dial (200)
Send Resolution (dpi)	Push: Up to 600 x 600 Pull: Up to 600 x 600
Communication Protocol	File: FTP(TCP/IP), SMB3.11 (TCP/IP), WebDAV E-mail/Fax: SMTP, POP3
File Format	Standard: TIFF (MMR), JPEG <sup>1</sup> , PDF (Compact, OCR (Text Searchable), Optimize PDF for Web, Format to PDF/A-1b, Trace & Smooth, Encrypt), XPS (Compact, OCR (Text Searchable)), PDF/XPS (Device Signature, User Signature), Office Open XML (PowerPoint, Word) <sup>1</sup> Single-Page only.
Universal Send Features	Original Type Selection, 2-sided Original, Book to 2 Pages, Different-size Originals, Density Adjustment, Sharpness, Copy Ratio, Erase Frame, Job Build, Delayed Send, Preview, Job Done Notice, File Name, Subject/Message, Reply-to, E-mail Priority, TX Report, Original Content Orientation, Skip Blank Pages

Fax Specifications	
Maximum Number of Connection Lines	1
Modem Speed	Super G3: 33.6 kbps G3: 14.4 kbps
Compression Method	MH, MR, MMR, JBIG
Resolution (dpi)	400 x 400 (Ultra Fine), 200 x 400 (Super Fine), 200 x 200 (Fine), 200 x 100 (Normal)
Sending/Receiving Size	Sending: A3, A4, A4R, A5 <sup>1</sup> , A5R <sup>1</sup> , B4, B5 <sup>1</sup> , B5R <sup>1</sup> Receiving: A3, A4, A4R, A5, A5R, B4, B5, B5R <sup>1</sup> Sent as A4 <sup>2</sup> Sent as B4 short
FAX Memory	Up to 30,000 pages (2,000 Jobs)
Speed Dials	Max. 200
Group Dials/Destinations	Max. 199 Dials
Sequential Broadcast	Max. 256 Addresses
Memory Backup	Yes
Fax Features	Sender's Name (TTI), Selecting the Telephone Line (when sending fax), Direct Send, Delayed Send, Preview, Job Done Notice, TX Report, Interrupt Transmission, Sequential Broadcasting, Password/Subaddress Sending, Confidential Mailbox, 2 on 1 Log

Store Specifications	
Mail Box (Number Supported)	100 User Inboxes, 1 Memory RX Inbox, 50 Confidential Fax Inboxes Maximum 30,000 Pages (2,000 jobs) Stored
Advanced Box	Communication Protocol: SMB or WebDAV Supported Client PC: Windows®10/Windows®11 Concurrent Connections (Max.): SMB:64, WebDAV:3
Advanced Box Available Disc Space	Standard: 16 GB Approx. (With option: Max. 480GB)
Advanced Box Features	Authentication for Advanced Box Log-in, Sort Function, Printing a PDF File with a Password, imageWARE Secure Audit Manager Support, Search, File Preview, Authentication Management, Open to public, URI TX, Backup/Restore

Security Specifications	
Authentication and Access Control	User Authentication (Picture Login, Picture and PIN Login, Card Login, Username and Password Login, Function Level Login, Mobile Login), Department ID Authentication (Department ID and PIN Login, Function Level Login), uniFLOW® (PIN Login, Picture Login, Picture and PIN Login, Card Login, Card and PIN Login, Username and Password Login, Department ID and PIN Login, Function Level Login), Access Management System (Access Control) *including uniFLOW Online
Document Security	Print Security (Secure Print, Encrypted Secure Print, Forced Hold Printing, uniFLOW Secure Print <sup>1</sup> ), Receive Data Security (Confidential Fax In-box Forwarding Received Documents Automatically), Scan Security (Encrypted PDF, Device Signature PDF/XPS, User Signature PDF/XPS, Adobe LiveCycle® Rights Management ES2.5 Integration), BOX Security (Mail Box Password Protected, Advanced Space Access Control), Send Data Security (Setting for requesting password input per transmission, Restricted E-mail File send functions, Confirming FAX number, Allow/Restrict Fax Driver Transmissions, Allow/Restrict Sending from History, S/MIME Support), Document Tracking (Secure Watermark) <sup>1</sup> Requires uniFLOW Online/ uniFLOW
Network Security	TLS 1.3, IPsec, IEEE802.1X authentication, SNMP V3.0, Firewall Functionality (IP/MAC Address Filtering), WPA3 support (Wi-Fi), Dual Network Support (Wired LAN/Wireless LAN, Wired LAN/Wired LAN), Disabling Unused Functions (Enabling/Disabling Protocols/Applications, Enabling/Disabling Remote UI, Enabling/Disabling USB Interface), Communication Line Separation (G3 FAX, USB Port, Advanced Box, Scan and Send -Virus Concerns for E-mail Reception)
Device Security	Protecting SSD Data [SSD Data Encryption (FIPS140-2 Validated), SSD Lock], Standard SSD Initialize, Trusted Platform Module v2.0 (TPM), Job Log Conceal Function, Protecting MFD Software Integrity, Checking MFD Software Integrity & Platform Firmware Resiliency (NIST SP800-193) with Verify System at Startup, Automatic Recovery, Runtime Intrusion Detection, Common Criteria Certification(HCD-PP) (pending confirmation)
Device Management and Auditing	Administrator Password, Digital Certificate and Key Management, Audit Log, Cooperating with External Security Audit System (Security Information and Event Management), Image Data Logging, Security Policy Setting

Environmental Specifications	
Operating Environment	Temperature: 10 to 30°C Humidity: 20 to 80 % RH (Relative Humidity)
Power Source	220-240V, 50/60Hz, 10A
Power Consumption	Maximum: Approx. 2,400 W Sleep mode: Approx. 0.9 W <sup>1</sup> Typical Energy Consumption (TEC) <sup>2</sup> rating 1.56kWh <sup>1</sup> 0.9W sleep mode may not be possible in all circumstances due to certain settings. <sup>2</sup> As per USA Energy Star version 3.0

Consumables	
Toner Cartridges	NP65-54 Toner BLACK
Toner (Estimated Yield @ 6% Coverage)	56,000 pages

## Software and Printer Management

Tracking and Reporting	Universal Login Manager (ULM) uniFLOW Online (Optional)
Remote Management Tools	iW Management Console eMaintenance Content Delivery System
Scanning Software	Color Network ScanGear 2
Optimisation Tools	Canon Driver Configuration Tool
Platform	MEAP (Multifunctional Embedded Application Platform)
Document Publishing	iW DESKTOP

## Paper Supply Options

Paper Deck Unit-E1	Paper Capacity: 3,500 Sheets (80 gsm) Paper Type: Thin, Plain, Recycled, Colour, Heavy, Bond, Pre-punched, Letterhead Paper Size: A4, B5 Paper Weight: 52 to 256 gsm Power Source: from the Main Unit Dimensions (W x D x H): 340 x 630 x 572 mm (attached to the main unit) Weight: Approx. 34 kg
POD Deck Lite-C1	Paper Capacity: 3,500 Sheets (80 gsm) Paper Type: Thin, Plain, Recycled, Colour, Heavy, Bond, Transparency, Label, Pre-punched, Letterhead, Tab Paper Size: A3, A4, A4R, A5R, B4, B5R, B5 Custom Size: 139.7 x 182.0 mm to 297.0 x 487.7 mm Paper Weight: 52 to 256 gsm Power Source: 220-240V, 50/60Hz, 1.2A Dimensions (W x D x H): 633 x 686 x 574 mm (attached to the main unit) Weight: Approx. 68 kg

## Output Options\*

\* Paper capacity may vary with different paper type/size.

Copy Tray-R2	Provides a simple tray for basic output needs. Capacity: 250/100 Sheets (1-sided/2-sided, 80 gsm) Dimensions (W x D x H): 244 (420)* x 382 x 175 mm (*with tray extended)
Shift Tray-F1	Provides a simple tray with offset functionality. Capacity: 500 Sheets (Shift delivery)/250 Sheets (Straight delivery), (80 gsm) Dimensions (W x D x H): 366 (486)* x 547 x 256 mm (*with tray extended)
Staple Finisher-AC1	Tray Capacity (with 80 gsm paper): Upper Tray: A4, A5, A5R, A6R, B5: approx. 250 Sheets A3, A4R, B4, B5R: approx. 125 Sheets Mid Tray: Same as upper tray Lower Tray: A4, A5, A5R, B5: 3,000 Sheets A3, A4R, B4, B5R: 1,500 Sheets A6R: 250 Sheets Paper Weight: 52 to 256 gsm Staple Position: Corner, Double Staple Capacity: A4, B5: 65 Sheets (52 to 90 gsm), A3, A4R, B4: 40 Sheets (52 to 90 gsm) Eco Staple: A3, A4 5 Sheets (52 to 64 gsm) 4 Sheets (65 to 81.4 gsm) 3 Sheets (82 to 105 gsm) Staple On Demand: 65 sheets (52 to 90 gsm) Power Source: From the main unit Dimensions (W x D x H): 656 mm x 623 mm x 1,195 mm (when the extension tray and rotary tray are extended) Weight: Approx. 36 kg
Booklet Finisher-AC2	(Includes the above Staple Finisher-AC1 basic staple specifications.) Saddle Stitch Paper Size: A3, A4R, B4, Custom Size (195.0 x 270.0 mm to 297.0 x 431.8 mm) Saddle Stitch Staple Capacity: 20 sheets x 10 sets (52 to 81.4 gsm) (including 1 cover sheet up to 256 gsm) Non Staple Folded Bunch Capacity: Up to 3 sheets (52 to 105 gsm) Power Source: From the main unit Dimensions (W x D x H): 656 x 623 x 1,195 mm (when the extension tray and rotary tray are extended) Weight: Approx. 60 kg
2/3 Hole Puncher Unit-A1	(Requires the Staple Finisher-AC1 or Booklet Finisher-AC2) Two or Three Holes Acceptable Punch Paper Weight: 52 to 256 gsm Acceptable Punch Paper Size: Two holes: A3, A4, A4R, A5, B4, B5, B5R Three holes: A3, A4, B4, B5 Power Source: From the finisher
2/4 Hole Puncher Unit-A1	(Requires the Staple Finisher-AC1 or Booklet Finisher-AC2) Two or Four Holes Acceptable Punch Paper Weight: 52 to 256 gsm Acceptable Punch Paper Size: Two holes: A3, A4, A4R, A5, B4, B5, B5R Four holes: A3, A4 Power Source: From the finisher
4 Hole Puncher Unit-A1	(Requires the Staple Finisher-AC1 or Booklet Finisher-AC2) Four Holes Acceptable Punch Paper Weight: 52 to 256 gsm Acceptable Punch Paper Size: Four holes: A3, A4, A4R, A5, B4, B5, B5R Power Source: From the finisher
Document Insertion Unit-P1	(Requires either the Staple Finisher-AC1 or Booklet Finisher-AC2) Number of Trays: 1 Tray Capacity: 100 Sheets (with 80 gsm paper) Acceptable Paper Type: Thin, Plain, Recycled, Colour, Heavy, Coated, Bond, Letterhead, Tab Acceptable Paper Sizes: A3, A4, A4R, B4, B5, B5R Acceptable Paper Weight: 60 to 256 gsm Power Source: 100-240V, 50/60Hz, 1.0A Dimensions (W x D x H): 247 x 679 x 1,242 mm (attached to the device: width excluding document tray) Weight: Approx. 40 kg
Document Insertion / Folding Unit-J1	(Requires either the Staple Finisher-AC1 or Booklet Finisher-AC2) Number of Trays: 1 Supported Folding Type: Z-Fold, C-Fold Acceptable Paper Type: Insertion Unit: Thin, Plain, Recycled, Colour, Heavy, Coated, Bond, Letterhead, Tab Z-Fold/C-Fold: Thin, Plain, Recycled, Colour Acceptable Paper Sizes: Insertion Unit: A3, A4, A4R, B4, B5, B5R Z-Fold: A3, A4R, B4 C-Fold: A4R Acceptable Paper Weight: Insertion Unit: 60 to 256 gsm Z-Fold/C-Fold: 60 to 105 gsm Output Capacity (with 80 gsm paper): Insertion: 100 Sheets Z-Fold*: A3, B4: 30 Sheets A4R: 10 Sheets C-Fold: A4R: 40 Sheets *Z-Fold output to the Staple Finisher-AC1 or Booklet Finisher-AC2 Power Source: 100-240V, 50/60Hz, 1.0A Dimensions (W x D x H): 247 x 679 x 1,242 mm (attached to the device: width excluding document tray) Weight: Approx. 76 kg

## Hardware Accessories

Others	Utility Tray-B1 Tab Feeding Attachment Kit-B1 Numeric Keypad-A2 Finisher Jogger Kit-A1
--------	---

## System and Controller Options

Print Accessories	PCL International Font Set-A1 PS Printer Kit-BC1
Barcode Printing	Barcode Printing Kit-D1
System Accessories	Serial Interface Kit-K3 Copy Control Interface Kit-A1 Wireless LAN BOARD-F1
Storage Accessories	250GB SSD-A1 1TB SSD-A1 MEMORY Mirroring Kit-A1
FAX Accessories	Super G3 FAX Board-AX1 Remote Fax Kit-A1 IP FAX Expansion Kit-B1

## Other Options

Accessibility Accessories	ADF Access Handle-A1 Voice Guidance Kit-G1 Voice Operation Kit-D1
Staple Cartridges	Staple Cartridge-X1 Staple Cartridge-Y1
Heater Options	Reader Heater Unit-P1 Cassette Heater Unit-38 Paper Deck Heater-A1 (For Side Paper Deck-E1 only)



POWERED BY



<https://www.ddsgroup.com.au/canon-copiers/>



1300 174 277